

RotoGen

ELEVATE · INNOVATE · PRECISION

therotogen.com



**Smart Screw Tightening
Solution Provider**

RotoGen

ELEVATE · INNOVATE · PRECISION

Table of Content

RGE-A Series	3
RGE-B Series	4
RGE-C Series	5
RGE-D Series	6
RGE-TB Series	7
RGE-TC Series	8
RGE-BAT Series	9
RGE-L Series	10
RGE-Z Series	11
Smart Controller	12
Power Adapters	13
Accessories	14
Digital Torque Meter	15
Screw Feeding and Counting Machines	16
Air Blowing Feeder	17
Mounting Attachments	18

About the Company

Vision

RotoGen envisions a future where its innovative torque technology revolutionizes the assembly process across various industries, ensuring efficiency, reliability, and superior performance in every connection.

Mission

Our mission is to provide indispensable torque tool solutions and services, ensuring precision and quality to meet our customers' assembly needs, backed by a commitment to innovation and excellence.

Values

- ▶ **Accountability:** We stand by our products and decisions, ensuring excellence in meeting our customers' needs.
- ▶ **Integrity:** Trust and ethical practices are the cornerstones of our interactions and operations.
- ▶ **Passion:** Driven by our love for innovation, we strive to lead in the torque tool industry.
- ▶ **Teamwork:** We believe in the power of working together, achieving shared goals through mutual support.
- ▶ **Innovation:** Our commitment to continuous improvement and embracing new technologies defines our approach to solving assembly challenges.

For more information visit: therotogen.com

Model Selection Guide

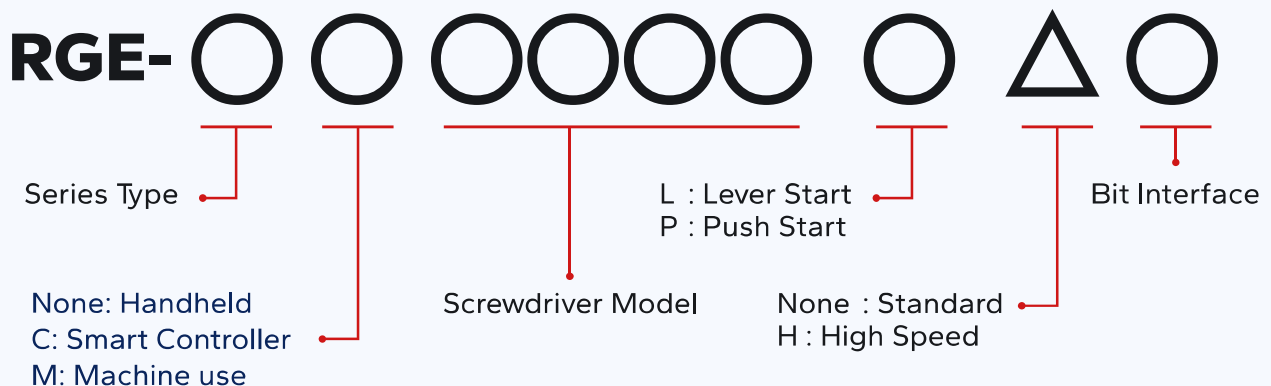

RGE-A Series



Torque Curve

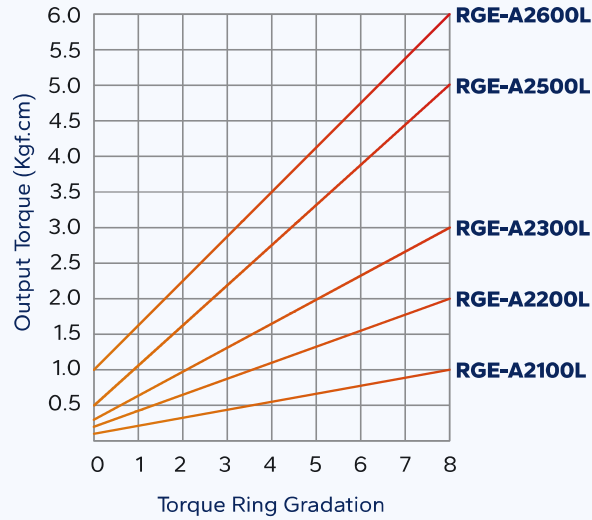

Dimensions

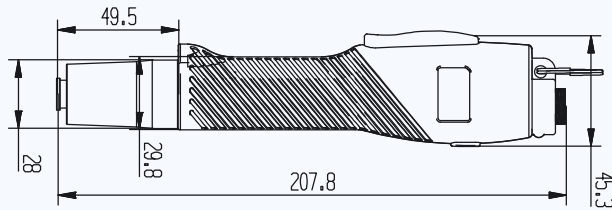

Accessories



BALANCER



VACUUM CUP



HOLDER



90° ELBOW HEAD



MAGNETIC RING

Technical Description

Model		RGE-A2100L	RGE-A2200L	RGE-A2300L	RGE-A2500L	RGE-A2600L
Torque Range	Kgf.cm	0.1-1.0	0.2-2.0	0.3-3.0	0.5-5.0	1.0-6.0
	Nm	0.01-0.1	0.02-0.2	0.03-0.3	0.05-0.5	0.1-0.6
Torque Adjustment		Stepless				
Repeatable Torque Accuracy (%)		±3				
Start Mode		Lever Start				
No-Load Speed (r.p.m) ±10%		1000 Standard (Customized can be done)				
Applicable Screws (mm)	Machine	0.6~1.2	0.8~1.6	1.0~2.0	1.2~2.5	1.4~2.8
	Self-Tapping	0.5~1.0	0.6~1.5	0.8~1.8	1.0~2.2	1.2~2.6
Weight (g)		245				
Length (mm)		208				
Input Voltage (DC)		DC-32V				
Power Consumption		40W				
Power Controller	Handheld	CTR-100				
	Handheld / Automation	CTR-100AT				
Screw Bit Interface						

RGE-B Series



Torque Curve

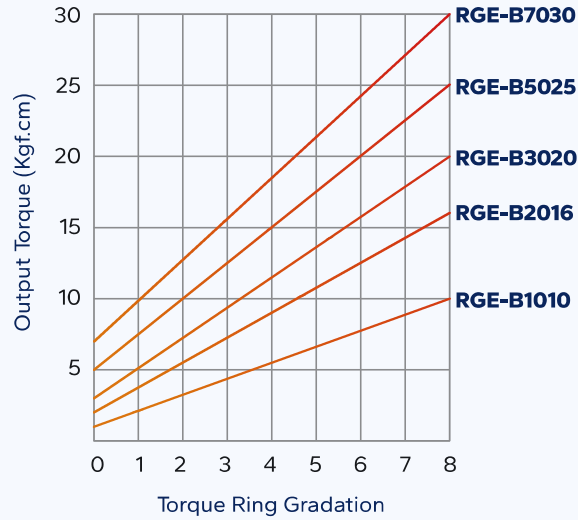

Dimensions

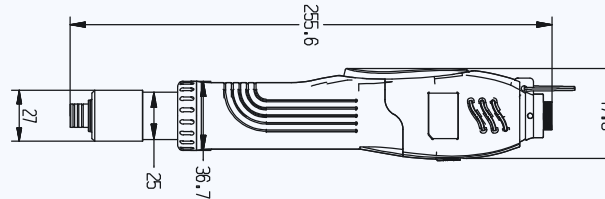

Accessories



BALANCER



VACUUM CUP



HOLDER



90° ELBOW HEAD



MAGNETIC RING

Technical Description

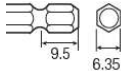
Model		RGE-B01010	RGE-B02016	RGE-B03020	RGE-B05025	RGE-B07030
Torque Range	Kgf.cm	1-10	2-16	3-20	5-25	7-30
	Nm	0.1-0.98	0.2-1.56	0.3-1.96	0.5-2.45	0.7-2.94
Torque Adjustment		Stepless				
Repeatable Torque Accuracy (%)		±3				
Start Mode		L: Lever Start / P: Push Start				
No-Load Speed (r.p.m) ±10%		1000 Standard / 2000 High Speed		1000 Standard		800 Standard
Applicable Screws (mm)	Machine	1.5~2.8	1.8~3.2	2.0~3.5	2.3~3.5	2.5~4
	Self-Tapping	1.4~2.6	1.6~3.0	1.8~3.2	2.1~3.2	2.3~3.5
Weight (g)		524				
Length (mm)		256				
Input Voltage (DC)		DC-32V				
Power Consumption		48W				
Power Controller	Handheld	CTR-200S				
	Handheld / Automation	CTR-200SAT				
Screw Bit Interface		SH6.35mm 				

RGE-C Series



Torque Curve

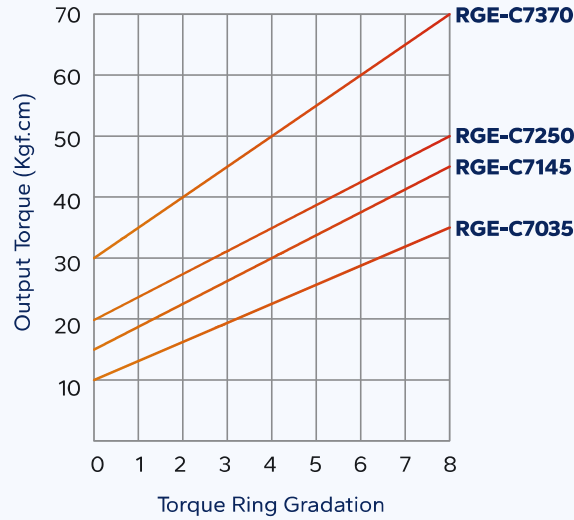

Dimensions

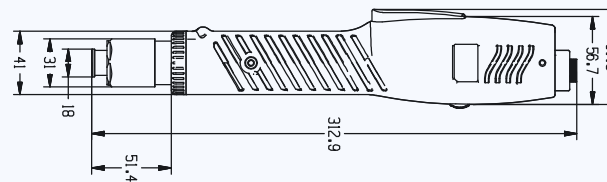

Accessories



BALANCER



VACUUM CUP



HOLDER



90° ELBOW HEAD



MAGNETIC RING

Technical Description

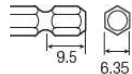
Model		RGE-CO7035△	RGE-CO7145○	RGE-CO7250○	RGE-CO7370○
Torque Range	Kgf.cm	10-35	15-45	20-50	30-70
	Nm	0.98-3.43	1.47-4.41	1.96-4.90	2.94-6.86
Torque Adjustment		Stepless			
Repeatable Torque Accuracy (%)		±3			
Start Mode		L: Lever Start / P: Push Start			
No-Load Speed (r.p.m) ±10%		800 Standard / 2000 High Speed Model	800 Standard		
Applicable Screws (mm)	Machine	2.6~4	3.5~4.5	4.0~5.0	5.0~6.0
	Self-Tapping	2.4~3.5	3.3~4.3	≤4	≤4.5
Weight (g)		800			
Length (mm)		313			
Input Voltage (DC)		DC-48V			
Power Consumption		75W			
Power Controller	Handheld	CTR-300S			
	Handheld / Automation	CTR-300SAT			
Screw Bit Interface		SH6.35mm 			

RGE-D Series



Torque Curve

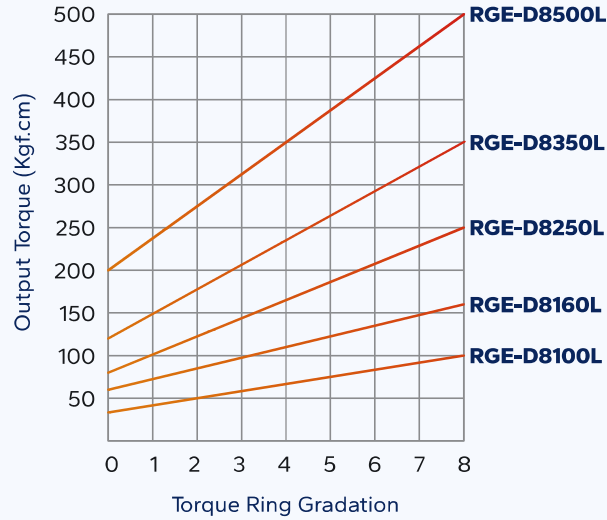

Dimensions

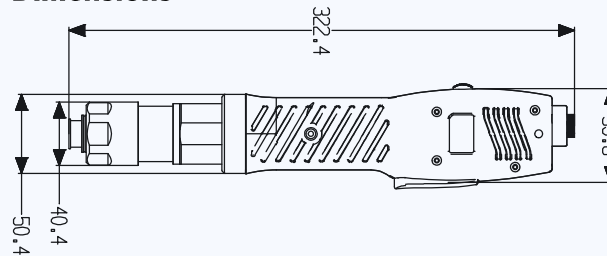

Accessories



BALANCER



VACUUM CUP



HOLDER



90° ELBOW HEAD



MAGNETIC RING

Technical Description

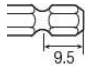
Model		RGE-D08100L	RGE-D08160L	RGE-D08250L	RGE-D08350L	RGE-D08500L
Torque Range	Kgf.cm	40-100	60-160	80-250	120-350	200-500
	Nm	3.92-9.80	5.88-15.69	7.85-24.51	11.77-34.32	19.61-49.03
Torque Adjustment		Stepless				
Repeatable Torque Accuracy (%)		±5				
Start Mode		L: Lever Start				
No-Load Speed (r.p.m) ±10%		500	350	200	150	80
Applicable Screws (mm)	Machine	6.0~8.0	8.0~10.0	10.0~12.0	12.0~14.0	14.0~20.0
	Self-Tapping	5.5~7.5	≤8	≤8	≤10	≤10
Weight (g)		1211				
Length (mm)		322				
Input Voltage (DC)		DC-48V				
Power Consumption		200W				
Power Controller	Handheld	CTR-400S				
	Handheld / Automation	CTR-400SAT				
Screw Bit Interface		SH6.35mm 				1/2" SQ

RGE-TB Series



Torque Curve

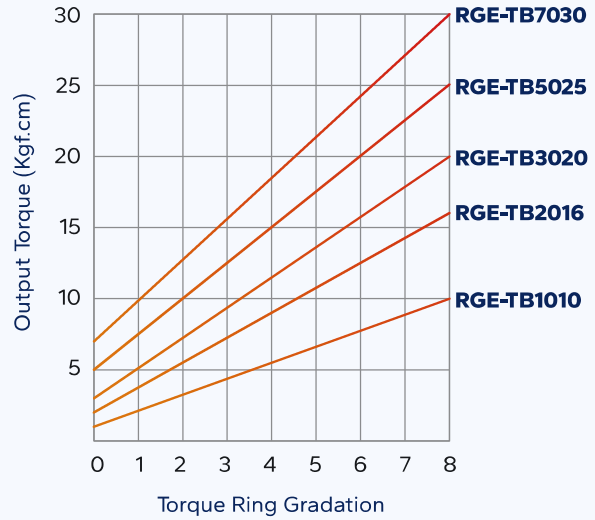

Dimensions

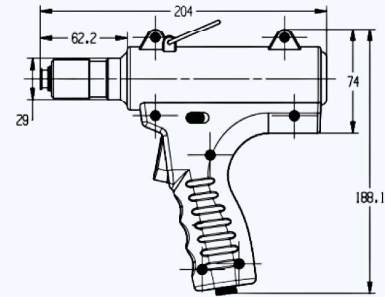

Technical Description

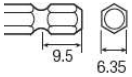
Model		RGE-TB○1010	RGE-TB○2016	RGE-TB○3020	RGE-TB○5025	RGE-TB○7030
Torque Range	Kgf.cm	1-10	2-16	3-20	5-25	7-30
	Nm	0.1-0.98	0.2-1.56	0.3-1.96	0.5-2.45	0.7-2.94
Torque Adjustment		Stepless				
Repeatable Torque Accuracy (%)		±3				
Start Mode		L: Lever Start				
No-Load Speed (r.p.m) ±10%		1000 Standard				800 Standard
Applicable Screws (mm)	Machine	1.5~2.8	1.8~3.2	2.0~3.5	2.3~3.5	2.5~4
	Self-Tapping	1.4~2.6	1.6~3.0	1.8~3.2	2.1~3.2	2.3~3.5
Weight (g)		660				
Length (mm)		204 x 188				
Input Voltage (DC)		DC-32V				
Power Consumption		48W				
Power Controller	Handheld	CTR-200S				
Screw Bit Interface		SH6.35mm 				

RGE-TC Series



Torque Curve

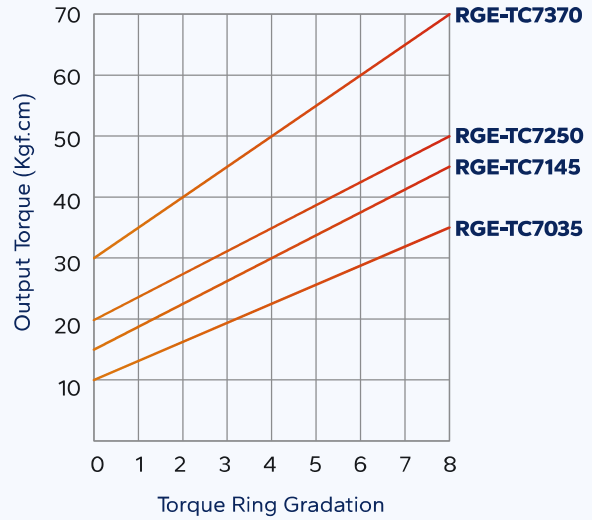

Dimensions

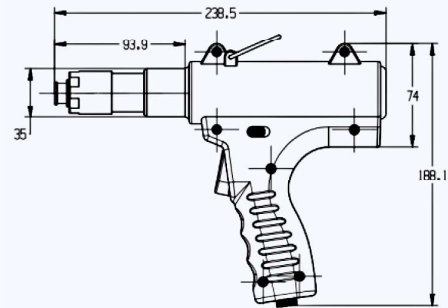

Technical Description

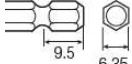
Model		RGE-TC07035△	RGE-TC07145	RGE-TC07250	RGE-TC07370
Torque Range	Kgf.cm	10~35	15~45	20~50	30~70
	Nm	0.98~3.43	1.47~4.41	1.96~4.90	2.94~6.86
Torque Adjustment		Stepless			
Repeatable Torque Accuracy (%)		±3			
Start Mode		L: Lever Start			
No-Load Speed (r.p.m) ±10%		800 Standard / 2000 High Speed Model		800 Standard	
Applicable Screws (mm)	Machine	2.6~4	3.5~4.5	4.0~5.0	5.0~6.0
	Self-Tapping	2.4~3.5	3.3~4.3	≤4	≤4.5
Weight (g)		920			
Length (mm)		239 x 188			
Input Voltage (DC)		DC-48V			
Power Consumption		75W			
Power Controller	Handheld	CTR-300S			
Screw Bit Interface		SH6.35mm 			

RGE-BAT Series



Torque Curve

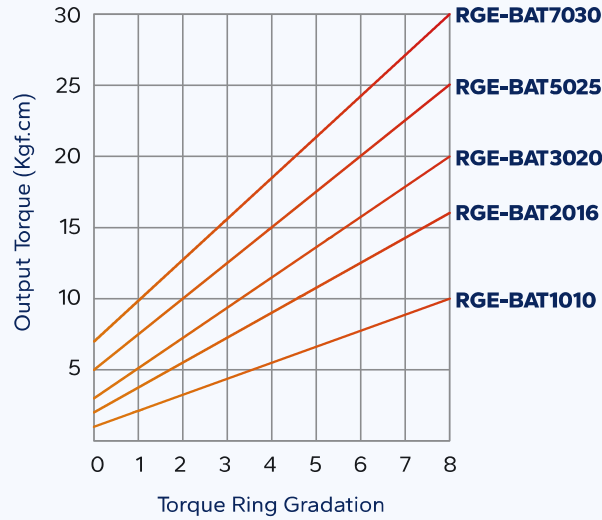

Dimensions

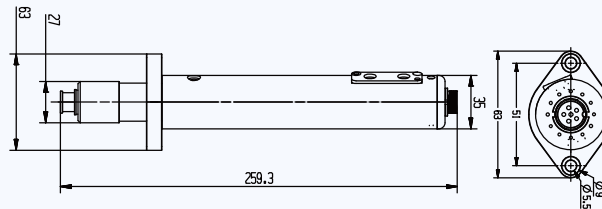

Wiring



Connection method

- ▶ S1 S2 port brake signal output (switch signal)
- ▶ Port negative pole
- ▶ R port start signal input
- ▶ K1 K2 start signal output
- ▶ R is connected to the normally open contact of the intermediate relay

Technical Description

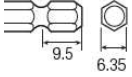
Model		RGE-BAT1010△	RGE-BAT2016△	RGE-BAT3020	RGE-BAT5025	RGE-BAT7030
Torque Range	Kgf.cm	1-10	2-16	3-20	5-25	7-30
	Nm	0.1-0.98	0.2-1.56	0.3-1.96	0.5-2.45	0.7-2.94
Torque Adjustment		Stepless				
Repeatable Torque Accuracy (%)		±3				
No-Load Speed (r.p.m) ±10%		1000 Standard / 2000 High Speed Model		1000 Standard		800 Standard
Applicable Screws (mm)	Machine	1.5~2.8	1.8~3.2	2.0~3.5	2.3~3.5	2.5~4
	Self-Tapping	1.4~2.6	1.6~3.0	1.8~3.2	2.1~3.2	2.3~3.5
Weight (g)		650				
Length (mm)		260				
Input Voltage (DC)		DC-32V				
Power Consumption		25W				
Power Controller	Automation	CTR-200SAT				
Screw Bit Interface		SH6.35mm 				

RGE-L Series

All torque segments from 0.1 to 350 kgf.cm are covered

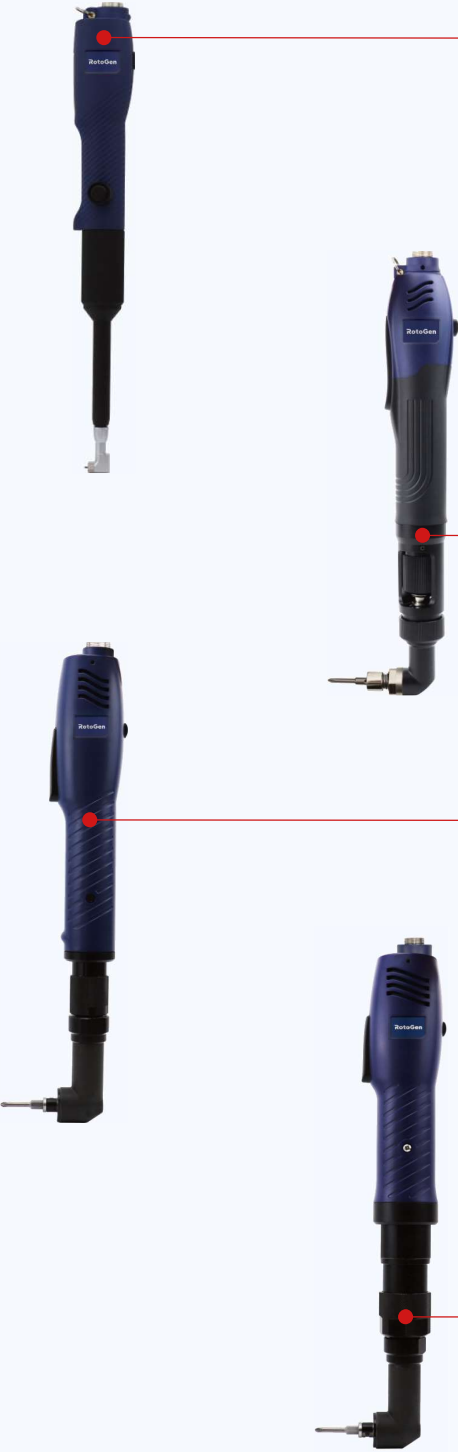

Dimensions

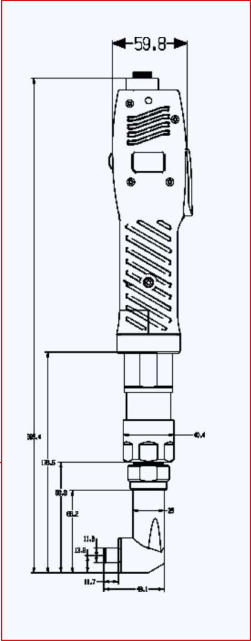
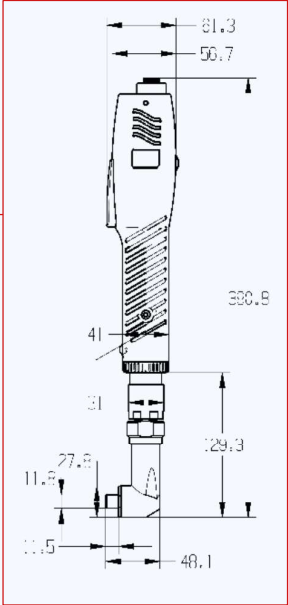
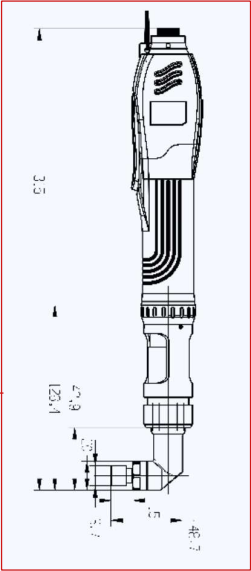
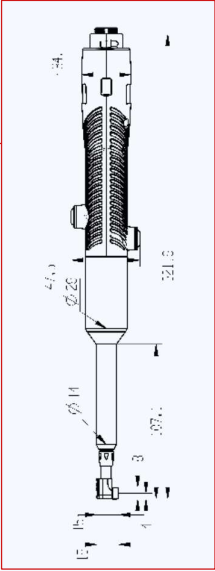

RGE-Z Series

Dimensions

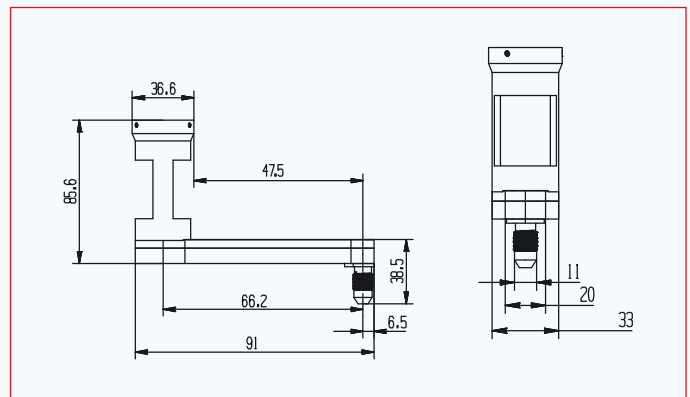
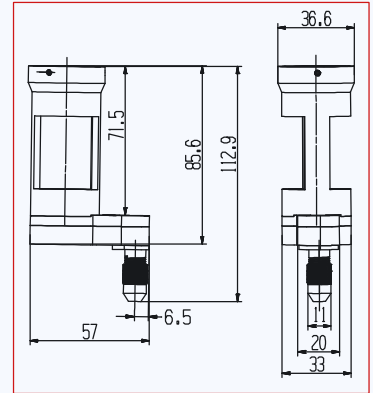
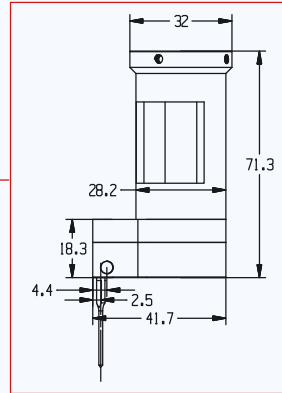

Technical Description

Model		RGE-Z0100LMIN	RGE-Z0200LMIN	RGE-Z0300L△	RGE-Z0400L△	RGE-Z0500L
Torque Range	Kgf.cm	0.1~1.0	0.3~1.5	1.0~10.0	2.0~16.0	4.0~20.0
	Nm	0.01~0.098	0.03~0.15	0.098~0.98	0.2~1.57	0.39~1.96
Torque Adjustment		Torque Adjustment Method		Stepless		
Repeatable Torque Accuracy (%)		±3				
Start Mode		L: Lever Start				
No-Load Speed (r.p.m) ±10%		1000 Standard		1000 Standard / 2000 High Speed Model		1000 Standard
Applicable Screws (mm)	Machine	0.8~1.2	1.0~1.5	1.2~2.0	1.5~2.5	2.0~3.0
	Self-Tapping	0.6~1.0	0.8~1.3	1.0~1.8	1.2~2.3	1.8~2.8
Input Voltage (DC)		DC-32V				
Power Consumption		25W				
Power Controller	Handheld	CTR-200S				
Screw Bit Interface		Can be customized according to actual products				